

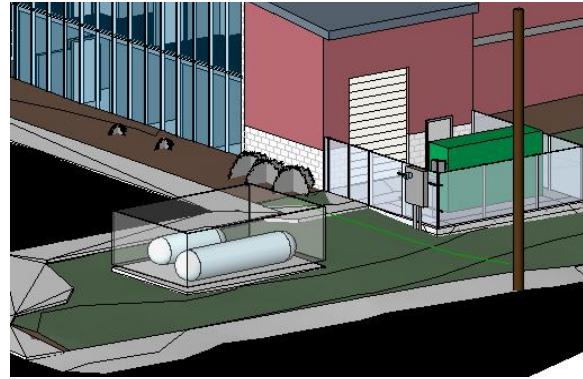

# Gilliam County Courthouse Back-up Generator

Condon, Oregon



Project Type:

***Emergency back-up power generator  
for public courthouse***

Size:

**80 kW**

Project Cost:

**\$83,000**

Pillar's Responsibilities:

***Conceptual Design  
Mechanical & Electrical Design (via  
MFIA Engineers, Inc. as sub-consultant)  
Civil Design  
Structural Design  
Permit Coordination  
Project Management***

Sub consultants:

***MFIA, Inc. Consulting Engineers***

Client:

***Gilliam County***

This project was funded largely by a FEMA grant to provide back-up power for emergency management services operated out of the Courthouse.

Pillar selected MFIA to provide consulting services for electrical and mechanical design services. The first challenge was to determine a cost-effective way to provide power to necessary areas. After studying the issue, the project team determined it was probably most cost effective and least disruptive to back-up the entire facility.

Locating the generator was challenging in that the location was constrained by the existing power supply, existing building services, propane tanks and the proximity of a public street.

This project was brought in well under the original cost opinion.

**FACILITIES**

for more information contact Jeff Schott, P.E.. at 541-993-2480



[www.pillar-inc.com](http://www.pillar-inc.com)